

Product introduction

Micro-resistance ball type check valve's disc is a ball coated with rubber and dependant on the line pressure the ball can roll in the chute in the body to open or close the valve without any noise and water-hammering and with good sealing capability . The flow rate is much with little resisting force and little pressure loss . It can be installed vertically or horizontally and widely used at the outlet of pump in cold water's, hot water's ,industry's and sewage's pipeline system .

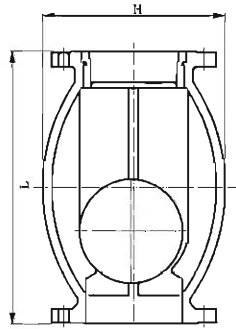

HQ44X-16
DN50-350

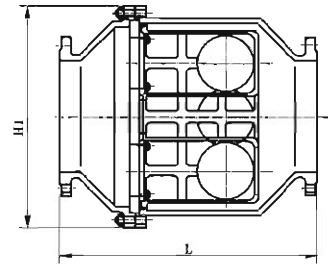

HQ45X
DN300-1000

Main technical parameter

- Nominal pressure :1.0-1.6
- Nominal diameter :50-1000mm
- Service : water and weak corrosive fluid
- Working temperature : 0-80
- Flanged end : GB/T 17241.6 GB/T 9113
- Inspection and test : GB/T 13927 API 598

Typical installation diagram

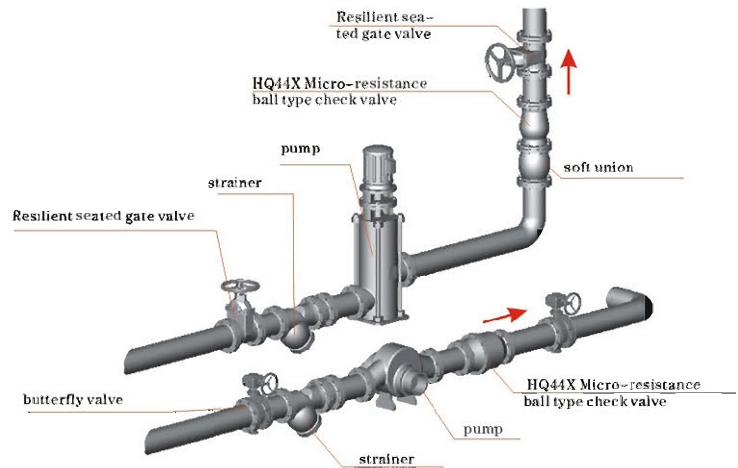

Material

part	body	disc	spring	seat
Material	Cast iron ductile cast iron , cast steel	Cast copper, stainless steel	Stainless steel	Copper , steel

Main dimensions

Unit : mm

DN	50	65	80	100	125	150	200	250	300	350	400	450	500	600	700	800	900	1000
L	203	216	241	292	330	356	495	622	698	781	914	978	978	1295	1448	1600	1760	1900
H	180	210	225	245	280	320	380	450	470	500								
H1							510	570	640	715	815	825	980	1155	1260	1350	1660	1700