

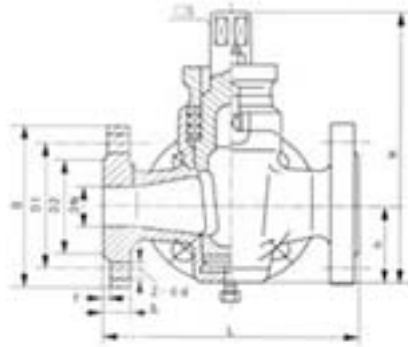

3-way, Flange Type Plug Valve



X44W-1.0



X44W-1.0

3-way, Flange Type Plug Valve

Main Performance Specification

| Model | Nominal pressure (MPa) | test pressure (MPa) | | Suitable medium | Suitable temp |
|-----------|------------------------|---------------------|---------|-----------------|---------------|
| | | Shell | Sealing | | |
| X43W-1.0T | 1.0 | 1.5 | 1.1 | Water oil & gas | ≤100 |
| X43T-1.0 | 1.0 | 1.5 | 1.1 | Water oil & gas | ≤100 |
| X43W-1.0 | 1.0 | 1.5 | 1.1 | Water oil & gas | ≤100 |

Main Size

| Nominal Pressure (MPa) | DN(mm) | Size(mm) | | | | | | | |
|------------------------|--------|----------|-----|-----|-------|-------|-----|-----|-----|
| | | L | D | D1 | D2 | Z-φd | □S | h | H |
| 1.0 | 15 | 145 | 95 | 65 | 45 | 4-φ14 | 14 | 26 | 99 |
| | 20 | 145 | 105 | 75 | 55 | 4-φ14 | 14 | 34 | 124 |
| | 25 | 145 | 115 | 85 | 56 | 4-φ14 | 17 | 38 | 133 |
| | 32 | 165 | 135 | 100 | 78 | 4-φ18 | 19 | 45 | 152 |
| | 40 | 190 | 145 | 110 | 85 | 4-φ18 | 22 | 55 | 212 |
| | 50 | 200 | 160 | 125 | 100 | 4-φ18 | 27 | 74 | 260 |
| | 65 | 230 | 180 | 145 | 120 | 4-φ18 | 32 | 82 | 295 |
| | 80 | 260 | 195 | 160 | 135 | 4-φ18 | 36 | 95 | 327 |
| | 100 | 300 | 215 | 180 | 155 | 8-φ18 | 46 | 135 | 425 |
| | 125 | 350 | 245 | 210 | 185 | 8-φ18 | 50 | 154 | 482 |
| | 150 | 400 | 280 | 240 | 210 | 8-φ23 | 55 | 172 | 512 |
| | 200 | 480 | 335 | 295 | 265 | 8-φ23 | 75 | 195 | 605 |
| | 250 | 530 | 390 | 350 | 320 | 8-φ23 | 85 | 230 | 660 |
| 300 | 610 | 440 | 400 | 368 | 8-φ23 | 100 | 263 | 760 | |



BIAOYI

3-way, Flange Type Plug Valve

3-way, Flange Type Plug Valve

Main Parts Materials

| Past name | Body | Plug | Gland | Packing |
|-----------|-------------|--------------|------------|---------|
| X44W-1.0T | cast copper | cast coppe | cast coppe | |
| X44T-1.0 | cast iron | cast uranium | cast iron | |
| X44W-1.0 | cast iron | cast iron | cast iron | |