

100D water-level valve

Product introduction 100D water-level valve is of diaphragm type, can adjust the level height of water box or water tower. It is controlled by the float ball, when the level reaches to the setting value, the valve sends the related signal to the pump and the pump stop supplying water; when the level is shorter than the setting level, the pump automatically open to supply water. This kind of valve runs stably and prevent water-hammering when the pump start to run and stop, so prevent overpressure. It is used in supply system of water box and water tower. It is easy to maintain. This kind of valve is quick and durable and can control the water level precisely and is not interrupted by the pressure. This kind of valve can close without any leak and it is reliable.

Structure diagram

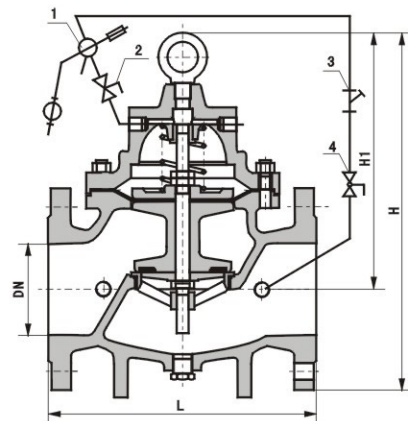

1 pilot valve 2 little ball valve
3 strainer 4 little ball valve

Installation diagram

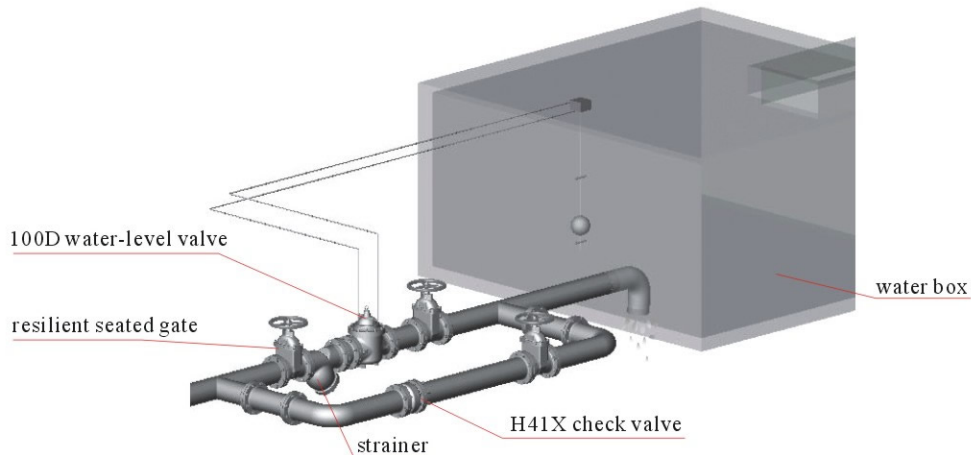

unit: mm

Main dimension	DN	20	25	32	40	50	65	80	100	125	150	200	250	300	350	400	450
L	150	160	180	200	203	216	241	292	330	356	495	622	698	787	914	978	
H	212	212	212	265	265	310	350	460	520	570	695	780	905	1025	1080	1030	
Hi	179	179	179	210	210	215	245	305	365	415	510	560	658	696	735	735	